

**ITEM 10. MOBILE CRANE – TEMPORARY ROAD CLOSURES – GEORGE
STREET SYDNEY**

TRIM RECORD NO: 2015/309879

RECOMMENDATION

It is recommended that the Committee endorse the temporary road closure of George Street, between Park and Market Streets, Sydney, from 3am on Sunday 14 June to 4am on Monday 15 June 2015; and from 3am on Sunday 28 June to 4am on Monday 29 June 2015, subject to the following conditions:

- (A) The Applicant must comply with the temporary road closure conditions as mentioned in Schedule C of this Agenda.
- (B) The Applicant must comply with any other conditions imposed by City's Construction Regulation Unit.
- (C) The Applicant has indicated the 12 and 19 July 2015 as an alternative date for the above work as a contingency for inclement weather.
- (D) The Applicant must contact the Sydney City Police to obtain a separate police permit and to discuss deployment of user pay police for the road closure.
- (E) The Applicant is to obtain a Road Occupancy Licence from the Transport Management Centre prior to commencement of works.
- (F) The Applicant must consult the Hilton Hotel and resolve any reasonable concerns about the proposed closure to the satisfaction of the City.
- (G) If the above closure dates conflict with any Light Rail works, other major works or special events, they may be changed to new dates in consultation with the Transport Management Centre and the Sydney City Police.
- (H) The Applicant must provide a telephone number of the supervisor responsible for the proposed closure and include contact details in the notification letters to be distributed to affected stakeholders.
- (I) The Applicant must contact Sydney Buses and arrange and pay for the rerouting of bus services around the closures, the temporary relocation of bus stops and any additional staff required.

DECISION

BACKGROUND

Built Pty Ltd has applied for the temporary road closure of George Street, between Park and Market Streets, Sydney, from 3am Sunday 14 June to 4am Monday 15 June 2015; and from 3am Sunday 28 June to 4am Monday 29 June 2015.

COMMENTS

The proposed temporary road closure is required to allow a mobile crane to be used to remove the tower crane on the frontage of 478 George Street.

The Applicant has provided a site-specific Traffic Control Plan that includes details of barricades, signs, flagmen and other traffic devices to implement the proposed road closure.

There are currently no other approved temporary road closures proposed to take place on the same day in close proximity of this closure.

The temporary road closure will not affect any other properties, as local access will be provided at all times and alternative access routes are available nearby.

CONSULTATION

The Applicant will be required to notify affected stakeholders as stipulated in Schedule C.

FINANCIAL

All costs associated with the proposed closure will be borne by the Applicant.

ATTACHMENTS

Mobile Crane – Temporary Road Closures – George Street Sydney

Ajay Nayyar, Traffic Works Coordinator

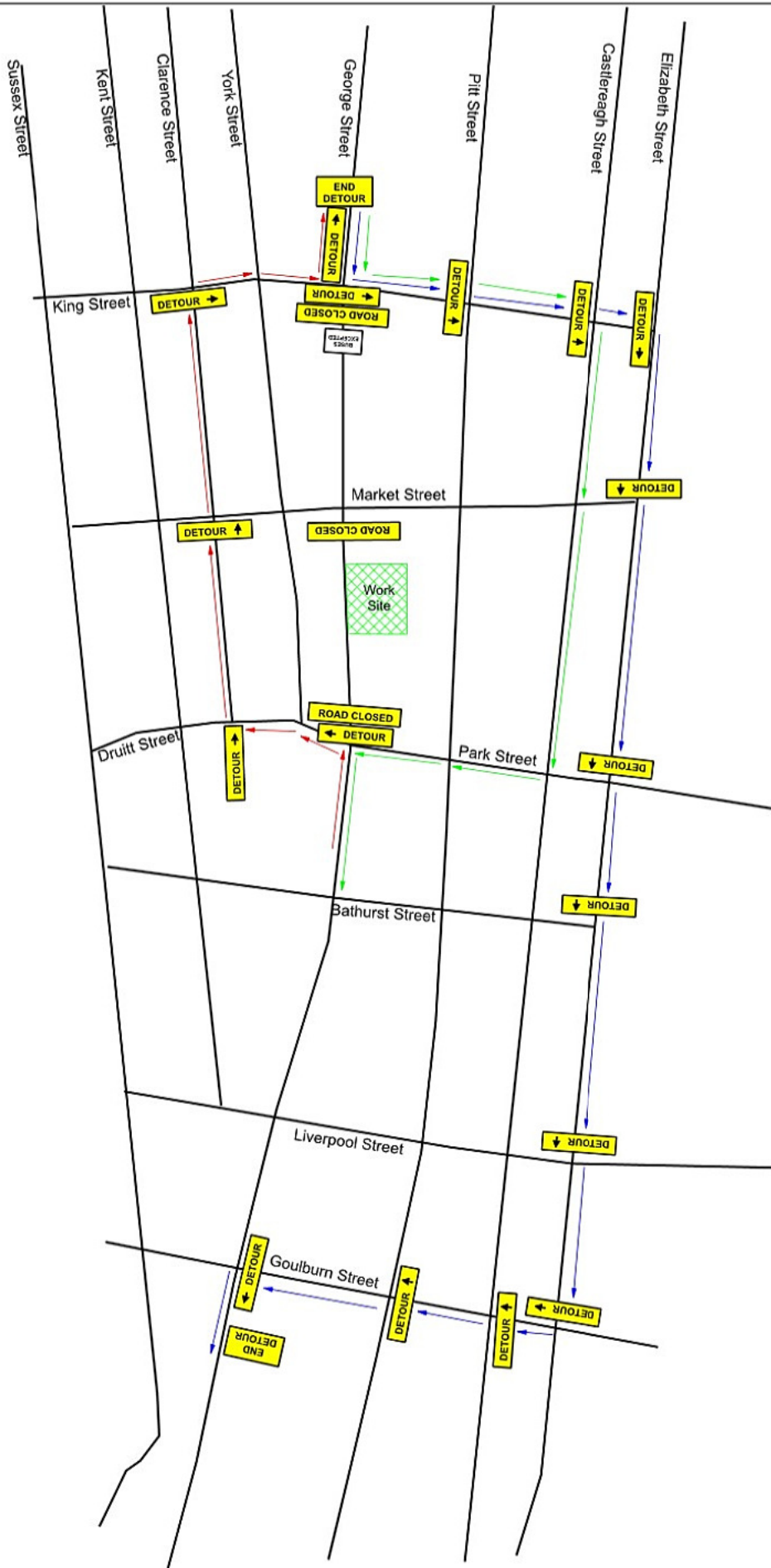
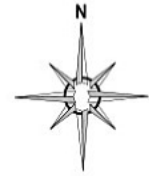

- ← North Bound Detour
- ← South Bound Detour
- ← Bus Detour

Design & Inspect Traffic Control Plans Certificate No. 3133014103	NSW Transport Roads & Maritime Services
Peter WIEECKI Expiry Date: 05/06/2015	 <small>This card is not proof of identity</small>

DM (Speed Limit)	Merge Taper Length	Lateral Taper Length	Buffer Length
45 or less	15	15	30
46 to 55	30	30	30
56 to 65	60	60	30
66 to 75	115	70	30
76 to 85	130	80	40
86 to 95	145	90	40
96 to 105	160	100	50
> than 105	180	110	50



Date: 30/04/2015 **Author:** Peter Wieteki License # 3133014103 **Project:** Built 478 George Street Detour Plan
EVS Group Australia Pty Ltd: 33 Jersey Street Hornsby NSW 2077 TCP No.: 01282015

Comments:
 This Traffic Control Plan is drawn in accordance with AS1742.3 and the RMS Traffic Control at Work Sites manual, it is to be implemented as such. This Traffic Plan is a GUIDE ONLY and can be altered on site but must be signed by an RTA Accredited person.
 Approach speed up to and equal to 60km/h
 Day/Night Class 1 reflective signs to be used
 RMS Accredited Traffic controllers to be employed
 All traffic controllers are to wear approved HI-Vis PPE

Modified By :

Date Modified :

Select/Modify Ticket # :

Expiry Date :

Signature :